

User Manual

Purple Rain | Black Thunder

TURBO



R G N T
MOTORCYCLES

Table of Content

1 Introduction	4
2 Safety Information	4
2.1 General Safety Information	4
3 High Voltage Information	5
3.1 High Voltage Warning Labels	6
3.2 Electrical System Information	7
4 Vehicle Identification Number (VIN)	7
4.1 Statutory Plate	8
5 Specifications	9
5.1 Motorcycle Description	10
5.2 Rider view description	12
5.3 Handlebar switches	13
5.4 CBS Brake System	15
5.5 Display	16
6 Safety Check Before Use	17
6.1 Tire Safety Check	17
6.2 Safety Check Brake System	17
6.3 Lights Safety Check	17
7 Operating the Motorcycle	18
7.1 Starting the motorcycle	18
7.2 Drive Away	19
How to Switch Power Modes:	19
7.3 Reverse Mode	21
7.4 Stopping the Motorcycle	22
7.5 Shut Down and Lock	22
7.6 Activating the Steering Lock	23
8 How to Charge	24
8.1 Stop Charging	25
9 Adjusting the Rear Suspension	26
10 Cleaning and Storage	26
10.1 Cleaning and Washing	26
10.2 Storage Recommendations	27
11 Wheels and Tires	27
11.1 Visual Inspection	28
11.2 Tire Pressure Maintenance Check	28
12 Maintenance and Service	28
12.1 Service Recommendations	28
12.2 Spare Parts	29
13 Customer Support Information	29
14 Warranty	30

Company Philosophy

Swedish Craftsmanship Meets Innovation

RGNT Motorcycles are meticulously crafted in Sweden, combining traditional craftsmanship with modern electric technology. Each bike is built to perfection, reflecting the precision and heritage of Swedish engineering.

A Fun and Sustainable Ride

Designed for both urban and off-road adventures, RGNT bikes offer a thrilling, yet environmentally friendly, riding experience. With a focus on zero emissions, our motorcycles are as kind to the planet as they are fun to ride.

Record-Breaking Performance

RGNT isn't just about style; we recently set a world speed record, proving our commitment to performance. Our motorcycles are a perfect blend of classic design and cutting-edge technology, pushing the boundaries of what electric bikes can achieve.

Turbo the concept

Progression toward 80s aesthetics with some 70s cues; a TURBO-inspired fan blade motor and sharper, bulkier lines blended with the previous design.

1 Introduction

Congratulations on your purchase of the Turbo! You are now the proud owner of an exceptional electric motorcycle. We hope that your experience with electric riding brings you both excitement and satisfaction. Please take the time to read this manual carefully to understand how to operate and care for your RGNT motorcycle safely and effectively.

All data and information contained in this User Manual are non-binding. RGNT Reborn AB reserves the right to modify technical specifications, prices, colors, models, materials, services, designs, equipment, and other relevant details—whether material or otherwise—at any time and without prior notice or explanation. These changes may be made to reflect local requirements or due to updates in production.

For frequently asked questions, please refer to the FAQ section on our website: www.rgnt-motorcycles.com. If you are unable to find the information you need or experience any technical issues, contact your nearest authorized RGNT dealer. A list of all official partners is available on our website.

If there is no RGNT dealer in your country, you may reach out to RGNT Support via email at support@rgnt-motorcycles.com. When reporting an issue, please include your motorcycle's Vehicle Identification Number (VIN). The VIN is located on the steering neck of the frame and follows this format: VIN - YSH0330D1SV100000-.

2 Safety Information

Designed for Street Use Only: RGNT motorcycles are engineered specifically for road use and are not designed for off-road riding or racing. Avoid riding on rugged terrain or in environments not intended for street motorcycles.

Warning Labels: Always observe and respect any warning labels on the motorcycle, especially those indicating high voltage. These labels are critical to your safety and help prevent injury. Never attempt to disconnect or touch high-voltage components without taking proper precautions.

Battery Handling: The motorcycle's battery stores a substantial amount of energy. Mishandling it can result in serious consequences. Always follow the manufacturer's guidelines when charging, storing, or servicing the battery.

Servicing and Maintenance: When performing maintenance or servicing, always adhere to the instructions provided in this manual. For procedures involving high-voltage systems or components with potential safety risks, it is recommended to consult a certified technician.

2.1 General Safety Information

To ensure a safe and enjoyable riding experience, please follow these essential safety recommendations:

Wear Proper Safety Gear: Always wear protective gear, including

- *Helmet:* Must comply with your local safety standards.
- *Riding Boots:* Full-height boots offer better ankle protection.
- *Gloves:* Motorcycle gloves enhance grip and protect your hands.
- *Protective Clothing:* Jackets, pants, and other protective gear help reduce injuries in case of a fall.

Ride Responsibly: Only individuals who can fully accept the responsibilities of riding should operate the RGNT motorcycle. Never allow untrained or inexperienced riders to use the bike.

Perform a Pre-Ride Safety Check: Before each ride, check that

- Tires are properly inflated.
- Brakes are fully functional.
- Lights and turn signals are operational.
- The battery is charged sufficiently for the trip.

Avoid Riding While Impaired: Never operate your motorcycle under the influence of alcohol, drugs, or medications that impair your judgment or reflexes. If you're feeling physically or emotionally unfit to ride, postpone your trip.

Obey Traffic Laws: Comply with all local traffic laws and regulations. These rules are in place to protect both you and others on the road.

Passenger and Load Safety: The RGNT motorcycle is designed to carry the rider and one passenger. Carrying additional weight affects the balance and handling of the bike. Always ensure that your load is secure and does not interfere with your ability to control the motorcycle.

Control Your Speed: Ride at speeds appropriate for the road conditions, weather, and traffic. Excessive speed reduces your reaction time and increases the risk of accidents.

By following these guidelines, you'll not only protect yourself and others but also get the most enjoyment out of your RGNT motorcycle. Ride smart. Ride safe. And enjoy the road ahead.

3 High Voltage Information

Your RGNT electric motorcycle is equipped with a high-voltage battery system, which must be handled with extreme care. Improper handling can result in serious injury or even death.

If you choose to modify or replace components on your RGNT motorcycle, please note that such actions may void your warranty. It is highly recommended that any work on the motorcycle—especially concerning the high-voltage system—be carried out by a certified technician or your local RGNT dealer. Always consult with your dealer before attempting any self-servicing.

A High-Voltage Warning symbol is used to mark areas on the vehicle where high-voltage components are present and pose a risk. This warning is represented by a yellow, triangular icon like the one shown below:



NOTE: Always treat high-voltage components with the utmost caution. If you are unsure about any part of the vehicle's electrical system, seek professional assistance immediately. Do not tamper with, modify, or attempt to repair any part of the high-voltage system. Doing so is dangerous and strictly prohibited.

3.1 High Voltage Warning Labels

Your RGNT electric motorcycle is equipped with a high-voltage battery system, which must be handled with great care. Improper handling can result in serious injury or death.

Areas of the motorcycle that contain high-voltage components are clearly marked with a yellow High-Voltage Warning symbol. This triangular symbol is used to alert you to potential electrical hazards. On the Turbo model, High-Voltage Warning Labels are located on both sides of the battery, on the motor (located in the rear wheel), on the tank and on both sides of the triangle box.



WARNING: Always respect these labels and avoid opening, tampering with, or servicing components marked with high-voltage warnings unless you are a certified technician.

3.2 Electrical System Information

The Turbo is equipped with two electrical subsystems, High-voltage system (88V) and Low-voltage system (12V).

3.2.1 High Voltage System

The high-voltage system powers the main propulsion components of the motorcycle, including the traction battery, inverter, and motor. Never attempt to repair, modify, or perform any work on the high-voltage system yourself.

All service related to the high-voltage system must be performed by an RGNT-authorized Service Center with proper training and certification in high-voltage systems. High-voltage components are marked with warning labels and orange-colored cables. Warning labels must never be removed and orange cables must not be altered or recolored under any circumstances.

These indicators are critical for identifying high-voltage areas and must be respected at all times for your safety.

3.2.2 Low-Voltage System

The 12V low-voltage system powers all auxiliary systems on your RGNT motorcycle, such as headlights, turn signals, dashboard functions, and other accessories. Before working on any part of the low-voltage system, carefully read the relevant instructions. If you are uncertain about a procedure, always consult your closest authorized RGNT dealer for guidance.

4 Vehicle Identification Number (VIN)

The Vehicle Identification Number (VIN) is located on the right side of the steering stem neck. This unique, internationally recognized code provides essential information about your motorcycle, including Country of origin, Model and year, Vehicle description and serial number, and Ownership reference.

On the left side of the steering stem neck, you will find the statutory plate, which contains key manufacturing information.

IMPORTANT INFORMATION: Do not remove or alter the VIN. Doing so is illegal. Law enforcement uses the VIN to identify the rightful owner in case of theft. RGNT Service Centers use it to determine the correct parts and service manuals for your specific motorcycle.

4.1 Statutory Plate

The Manufacturer's Statutory Plate is located on the left side of the steering stem and includes the following information:

- Name of manufacturer
- Vehicle category - license category
- EU Type approval ID
- VIN (Vehicle Identification Number)
- Homologated max sound level
- Engine power / Max load kg
- Manufacturer Logo

Location of the statutory plate



This plate must remain intact and legible at all times, as it serves both regulatory and service-related purposes.

5 Specifications

GENERAL

Total Weight: 162 kg
Battery Weight: 51 kg
Maximum Load Mass: 322 kg (Total weight for rider, passenger, cargo & accessories)
Frame: Steel Tube Construction
License requirements: EU: A1 Vehicle class: L3e-A1
Top Speed: 117 km/h

MEASUREMENTS

Length: 2102 mm
Width: 840 mm
Height: 1089 mm (without mirrors)
Wheelbase: 1404 mm
Seat Height: 830 mm
Ground Clearance: 423 mm (lowest part of frame)

CHARGING

Battery Cells: Li-On
Energy in Battery: 7.4 kWh Type 2 Charging Stations and standard 110/220V wall outlets
Maximum Charging Power: 1.8kW
Charging Time: 20 – 80% (approx 2 hours)

DRIVE-TRAIN

Peak Power: 46 kW
Continuous Power: 11 kW
Charging time: 0-100%: 6h
Type: Hub Motor / Brushless DC Motor
Peak Torque: 540 Nm
Cooling: Air cooled

CBS BRAKES

Hand levers for both front and rear brake (Combined Brake System)

Front

J.Juan CBS Brake System
Disc Brake: 300 mm floating disc 4.5 mm thickness stainless steel
Brake pads: Sintered

Rear

J.Juan CBS Brake System
Disc Brake: 220 mm disc 4 mm thickness stainless steel
Brake pads: Sintered

WHEELS

Front

Rim: 18*2,5" cast aluminium
Tire: Dunlop D602 100/ 90-18"

Rear

Rim: 17*3.0" cast aluminum
Tire: Dunlop D602 130/80-17"

SUSPENSION

Rear: 340 mm adjustable spring preload
Front: 35 mm Paioli, Ceriani replica

5.1 Motorcycle Description

Motorcycle from the side



1. Rear Reflector
2. License Plate Light
3. Tail Light
4. Saddle
5. Saddle Strap
6. Rear Shock Absorber
7. Side Stand
8. Main Battery

9. Charging Port
10. Rear View Mirror
11. Display
12. Headlight
13. Front Fork
14. Fork Reflectors
15. Foot Stand Driver
16. Foot Stand Passenger

Rear View



Rear

1. Tail light
2. License plate holder
3. Rear turn indicator
4. Rear reflector
5. Rear view mirror
6. Rear wheel

Front View



Front

1. Rear view mirror
2. Display
3. Headlight
4. Turn indicator
5. Front fork
6. Front wheel

5.2 Rider view description



1. Display
2. Left rear view mirror
3. Left brake lever (Front & Rear brakes)
4. Left switch / Light switch control
5. Charging port (Type 2)
6. Right switch
7. Right brake lever (Front brake only)
8. Throttle grip / speed control
9. Right rear view mirror

5.3 Handlebar switches

Left handlebar control



Left side control

1. Headlight switch
2. Headlight "flash"
3. Hazard light
4. Right turn indicator
5. Horn: Warning signal
6. Left turn indicator

Right handlebar control



Right side control

1. Reverse
2. Power mode "up"
3. On/off
4. Menu
5. Drive mode: Drive/Park
6. Power mode: Down
7. Emergency Stop/Neutral

5.3.1 Information Stickers

These informational stickers are placed on the motorcycle for the rider's reference. The following section explains their locations and intended purposes.

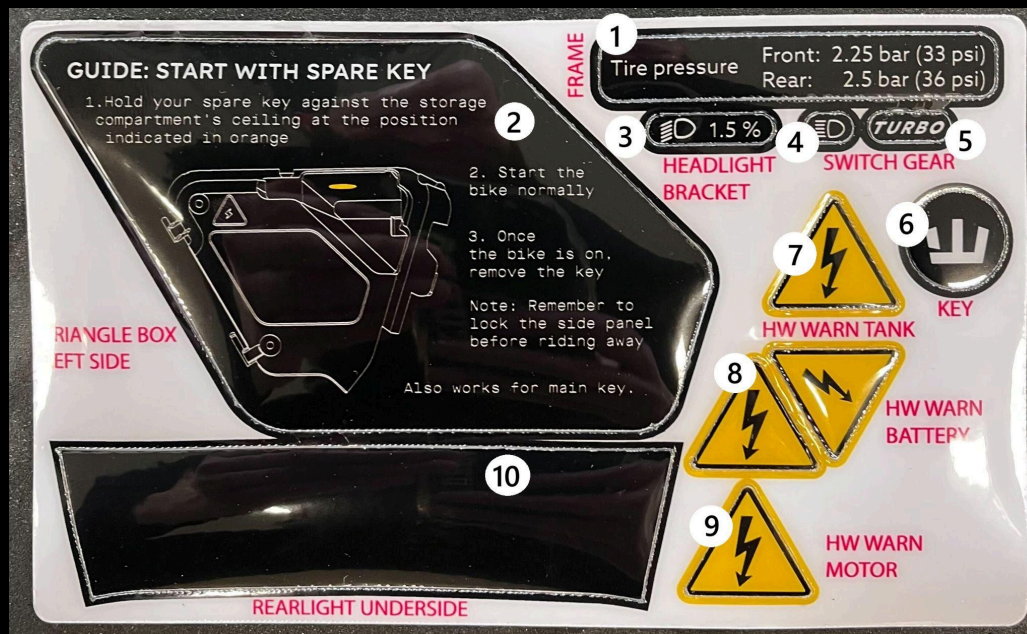

1. Tire pressure info / Locations: swing Arm
2. Guide to start with spare key / Location: Left glove compartment lid (Inside)
3. Headlight tilt information / Location: Headlight bracket
4. Headlight flash / Location: Left handlebar control
5. Switch drive mode up / Location: Right handlebar control
6. Key Sticker / Location: Main active key
7. High Voltage Warning / Location: Tank
8. High Voltage Warning / Location: Main Battery
9. High Voltage Warning / Location: Motor
10. Non reflector sticker / Location: Real light reflector

5.4 CBS Brake System

The Turbo is equipped with a Combined Brake System (CBS). Please note that CBS is *not* an Anti-lock Braking System (ABS). The braking system is fully controlled from the handlebars using the left and right brake levers:

- The left brake lever (1) engages both the front and rear brakes.
- The right brake lever (2) engages the front brake only.



NOTE: Since the CBS system does not include ABS, excessive pressure on the brake levers may cause the wheels to lock, particularly on slippery surfaces. Locked wheels can lead to extended braking distances and an increased risk of losing control or crashing.

For optimal braking performance and stability, always apply both the left and right brake levers together in a smooth, controlled manner.

5.5 Display

Below is the display tell tails and icons.



1. *Direction Indicator Symbol (Left/Right)*: Indicates activation of the left or right turn signals.
2. *Turtle Mode Icon*: This icon appears when power is temporarily restricted, typically due to the motorcycle being too hot or cold to operate at full capacity.
3. *Headlight Mode*: The motorcycle has three headlight modes: Position (Park), Low Beam, and High Beam.
4. *Environment Temperature*: Displays the outside temperature in degrees Celsius.
5. *Bluetooth*: Indicates the status of the Bluetooth connection.
6. *Environment Temperature*: Showing in Celsius degrees
7. *Power Mode*: Shows the currently selected power mode. The motorcycle has four power modes: Range (9kW), Normal (11kW), Dynamic (21 kW) and Turbo (46kW).
8. *Malfunction Indicator*: If this icon appears on the display, contact your local RGNT Dealer or Service Center as soon as possible for diagnostics and assistance. Dealer information is available at www.rgnt-motorcycles.com.
9. *Turbo Indicator*: Indicates when the motorcycle is operating in Turbo mode.
10. *Speed*: The current speed is displayed in kilometers per hour (km/h) by default. This can be changed to miles per hour (MPH).
11. *Drive Modes*: There are four drive mode indicators: Park (P), Neutral (N), Drive (D) and Reverse (R).

12. *Speedometer*: Displays the current speed of the motorcycle in either km/h or MPH.
13. *ODO & TRIP*: Odometer, "ODO", shows the total distance traveled by the motorcycle. This value cannot be reset. TRIP displays the distance traveled during the current ride and resets each time the motorcycle is turned off.
14. *Main Battery Charge/Heat Indicator*: Displays the battery's charge level. If the battery icon is red, the charge is below 9% and the motorcycle will automatically limit power mode to Range.

6 Safety Check Before Use

Before operating your RGNT electric motorcycle, it is essential to perform a quick safety check to ensure the vehicle is in proper working condition. Taking just a few moments for this routine inspection helps promote both your safety and the longevity of the motorcycle.

6.1 Tire Safety Check

Tread Depth: Inspect the tire tread for sufficient depth. While legal requirements may vary by country, we recommend a minimum tread depth of 1.5 mm across 80% of the tread surface. Please refer to local regulations for specific requirements.

Tire Pressure: Always check the air pressure of both tires before riding. The recommended pressures are:

- **Front Tire:** 2.25 bar (33 psi)
- **Rear Tire:** 2.5 bar (36 psi)

NOTE: Tire pressure specifications are also listed on the sticker located on the left swingarm of the motorcycle.

6.2 Safety Check Brake System

Brake Lever Functionality: Gently squeeze the left, then the right brake lever toward the handlebars. You should feel firm resistance, and each lever should stop short of touching the handlebar.

Brake Line Inspection: Perform a visual inspection of all brake lines. Check for any signs of oil leakage, cracks, or visible damage to the lines.

6.3 Lights Safety Check

Turn Signals: Activate the turn signal switch to the left and right. Confirm that all front and rear indicators flash appropriately.

Brake Light: While squeezing either brake lever, verify that the rear brake light illuminates.

Headlight: Cycle through all three headlight modes, checking that each one activates correctly.

Hazard Lights: Press the Hazard Warning Light button. Ensure that the warning icon appears on the display, and that all four turn indicators flash simultaneously.

7 Operating the Motorcycle

Before operating your RGNT motorcycle, it is essential to read the User Manual thoroughly. Doing so will help you avoid potential damage to the motorcycle and reduce the risk of accidents or personal injury.

This manual explains how to operate the Turbo model correctly, introduces its unique features, and provides useful tips for optimizing your riding experience. Always complete the safety check procedure (see Section 6) before starting your ride.

7.1 Starting the motorcycle

To start your RGNT motorcycle, follow these steps:

1. *Have your main key within range:* Keep the key within 1 meter (approx. 3 feet) of the seat area—such as in your jacket or pants pocket.
2. *Quick-press the ON button (1):* Press the ON button once. Do not hold it down.
3. *Indicator feedback:* The turn indicators will flash twice quickly, confirming that the motorcycle is powering on.
4. *Display activation:* All dashboard icons will briefly illuminate. The screen will then transition to the standard startup display.

Your motorcycle is now ready to ride.



7.2 Drive Away

To begin riding your RGNT motorcycle, follow these steps:

- A. *Fold up the side stand (1)*: Once the side stand is retracted, the motorcycle automatically switches from Park (P) to Neutral (N). At the same time, the headlight transitions from park light to low beam.
- B. *Press the D/P button (2)*: This activates Drive (D) mode. The selected power mode (default: *Normal*) will be displayed on the screen.
- C. *Twist the throttle*: Gently twist the throttle toward you to begin moving forward.



7.2.1 Power Modes

Your RGNT Turbo motorcycle features four selectable power modes, each with a specific maximum power output. These modes allow you to tailor performance based on your preferences and conditions:

Mode	Max Power Output	Description
Range	9 kW	Energy-efficient mode for max range
Normal	11 kW	Balanced everyday riding
Dynamic	27 kW	Sportier performance, quick response
Boost	46 kW	Maximum performance, short bursts

How to Switch Power Modes:

The drive modes can be changed during riding, use the control switch located on the right handlebar:

- A. Press the M button (1) to decrease the power level
- B. Press the upper switch (2) to increase the power level



Dynamic and Boost modes generate more heat than Normal or Range. If the drive system becomes too hot, higher power modes may be automatically restricted to protect the motorcycle.

Available power modes depend on battery level:

Battery Level	Available Modes
100%-30%	Boost, Dynamic, Normal, Range
30%-25%	Dynamic, Normal, Range
25%-8%	Normal, Range
Below 8%	Range only

Always monitor your battery percentage and system temperature to ensure optimal performance.

7.3 Reverse Mode

Your RGNT motorcycle is equipped with a Reverse Drive Mode to assist with low-speed backward maneuvers. To activate Reverse Mode:

- A. Squeeze and hold the left or right brake lever (1).
- B. Press and hold the “R” button (2) until the Reverse Mode is shown on the display.
- C. Gently twist the throttle (3) toward you to move the motorcycle backward.
- D. To return to Drive (D) mode, repeat steps 1 and 2.



NOTE: Reverse speed is intentionally limited for safety, but still provides enough torque—use with caution.

7.4 Stopping the Motorcycle

To stop the motorcycle:

- A. Use both the left and right brake levers to bring the motorcycle to a full stop.
- B. Press the red D/P switch (1) to shift the motorcycle into Park (P). The Park icon will appear on the display.
- C. Fold down the side stand.



NOTE: Folding the side stand automatically switches the motorcycle to Park (P) mode.

7.5 Shut Down and Lock

To safely shut down and lock your motorcycle:

- A. Ensure the motorcycle is in either Neutral (N) or Park (P).
- B. Quick-press (0.5 seconds) the OFF button (1) to power off the motorcycle.



NOTE: The main key must be within approximately 1 meter (3 feet) of the seat area. The motorcycle cannot be shut down unless it is in Neutral or Park mode.

7.6 Activating the Steering Lock

The RGNT motorcycle features an anti-theft steering lock system. When engaged, the handlebars are locked to the left, making the motorcycle immobile.

To activate the Steering Lock:

- A. Place the motorcycle on the side stand.
- B. Turn the handlebars fully to the left until they reach the steering stop.
- C. Press and hold the OFF button (1) for 3 seconds. You will hear the locking mechanism engage, confirming that the steering is locked.

Handlebar position



Right handlebar switch



If the lock doesn't engage:

- Slightly wiggle the handlebars left and right.
- Ensure they are fully turned to the steering stop.
- Retry by pressing and holding the OFF button for 3 seconds.

8 How to Charge

To charge your RGNT motorcycle, follow these steps:

- A. Open the charging lid by pressing the button on the charging lid forward to open it. See image below to the left.
- B. Connect the charging cable by inserting the Type 2 charging handle into the charging port. See image below to the right.



The charging port has built-in LED indicators that show the status of the charging process:

- **Pulsing green light:** Charging is in progress.
- **Green and red lights on simultaneously:** The cable is connected, but charging has not yet begun. This is normal for the first few seconds.
- **Solid red light:** A charging fault has occurred. Disconnect the cable and retry. If the issue persists, contact RGNT Support.

See charge cable connected below.



NOTE: The charger will not operate if the traction battery temperature is below -2°C (28°F) or above 45°C (113°F). The recommended charging temperature is between 5°C and 20°C (41°F – 68°F) for optimal battery performance and longevity.

Charge the battery at least once every 30 days, even if the motorcycle is not in use. For long-term storage (more than 30 days), maintain the battery at approximately 50% charge. This helps preserve battery health and extend its lifespan.

8.1 Stop Charging

- A. Unplug the charger connector by pulling it upward. See image below.



- B. Close the charge port lid.

9 Adjusting the Rear Suspension

Your RGNT Turbo is equipped with rear shock absorbers that feature adjustable spring preload (pre-tensioning). This allows you to fine-tune the suspension based on rider weight, load, and personal riding preference.

Adjustments can be made by an RGNT Authorized Service Center or by the owner using a proper shock adjustment tool.

How to adjust the rear suspension:

- A. Preparation: Ensure the motorcycle is on a stable surface or center stand, and that you have the appropriate shock adjustment tool for best results.
- B. Unlock the Adjustment Ring: Turn the top ring (lock ring) counter-clockwise by one full turn to loosen it.
- C. Adjust Spring Preload:
 - To increase suspension stiffness (for heavier loads or firmer handling), turn the second ring from the top clockwise.
 - To decrease stiffness (for a softer ride), turn the second ring from the top counter-clockwise.
- D. Lock the Setting: Once the desired preload is set, turn the top ring clockwise until it firmly locks against the second ring. Ensure both rings are tightly secured to maintain your chosen setting.

NOTE: Improper suspension settings can affect riding comfort and handling. Always ensure both sides are adjusted equally and consult a professional if unsure.

10 Cleaning and Storage

Proper cleaning and storage are essential for maintaining the performance, safety, and longevity of your RGNT motorcycle. Inadequate care can lead to rust, dirt accumulation, and damage to sensitive components. In some cases, failure to follow recommended practices may void the manufacturer's warranty if it results in avoidable damage.

10.1 Cleaning and Washing

Avoid Harsh Chemicals! Do not use aggressive or abrasive cleaning products on plastic or painted surfaces. Avoid sponges or cloths that have been in contact with:

- Solvents or thinners
- Fuel or brake fluid
- Rust removers or inhibitors
- Antifreeze or battery electrolytes

Recommended cleaning method: Use a garden hose, clean sponge, or soft cloth with mild detergent and water.

- *Plastic Parts:* Take special care when cleaning parts like the dashboard, fenders, and side panels, which are more susceptible to scratching.
- *Rinse and Dry:* Rinse the motorcycle thoroughly with clean water to remove any detergent residue. Dry with a soft towel to prevent water spots.
- *Post-Cleaning Caution:* After washing, if you intend to ride soon, note that wet disc brakes and brake pads may require a longer braking distance until they dry fully.

IMPORTANT INFORMATION: Do NOT use a high-pressure washer. This may damage electrical components, seals, or delicate surfaces.

10.2 Storage Recommendations

Storage Environment:

- Store the motorcycle in a garage whenever possible.
- If indoor storage is not available, use a motorcycle cover to protect against environmental exposure.

Long-Term Storage (More than 6 weeks):

- Option 1: Connect a 12V maintenance charger to keep the low-voltage system in good condition.
- Option 2: Remove the main fuse, located behind the left side panel, to reduce battery drain.

Battery Care for Storage:

- Charge the main battery to 30–70% before storage to preserve battery health.
- Ideal storage temperature: 10°C to 25°C.

Temperature Effects:

- Charging is not possible if the battery is below -2°C.
- Driving performance is limited below 8°C. The Turtle Drive icon on the display indicates reduced power.
- Drive modes may also be restricted until the battery temperature returns to normal.

IMPORTANT INFORMATION: Storing the motorcycle outside the recommended temperature range may permanently damage the battery, reduce its performance, and shorten its lifespan. This can result in decreased range, power limitations, and overall reduced efficiency.

11 Wheels and Tires

Always use tires that are recommended and approved by RGNT. Installing unapproved tires may negatively affect handling and vehicle safety. This also violates the vehicle's homologation, making it illegal to operate in most regions.

Original Factory-Mounted Tires:

Front: Dunlop D602F 100/ 90-18" M/C 65P

Rear: Dunlop D602 130/80-17" M/C 65P

11.1 Visual Inspection

Each time before riding your motorcycle, check both the front and rear tires to be sure they are not cut or show any other mechanical damage. If damage occurs, replace the tire immediately. Check that tire tread depth is sufficient according to the laws and regulations of the country where the vehicle is being used. If the tread depth is less, replace the tire. Check the age of the tires and replace them if they are older than 5 years.

11.2 Tire Pressure Maintenance Check

Maintaining correct tire pressure is critical for optimal driving performance, stability, and safety. Incorrect tire pressure causes abnormal tire wear and may affect the handling of the motorcycle, increasing the risk of accidents.

How to check tire pressure:

- A. Remove the valve cap from the tire.
- B. Attach a pressure gauge and read the current pressure.
- C. Compare the value with the recommended pressures mentioned in this manual.
- D. Adjust by inflating or deflating as needed.
- E. Reattach the valve cap securely.

NOTE: Tire pressure information is also located on the sticker attached to the left swing arm of the motorcycle.

TIRE PRESSURE INDEX

Model: Turbo	Tire Pressure PSI	Tire Pressure BAR
Front	32 PSI	2.2 BAR
Rear	36 PSI	2.5 BAR

12 Maintenance and Service

Your RGNT electric motorcycle requires regular service and inspection to ensure safe and reliable performance. All service must be carried out by authorized RGNT Service Centers using trained personnel and the correct tools.

IMPORTANT INFORMATION: The vehicle includes a high-voltage system, which can cause serious injury or death if not handled by trained professionals.

12.1 Service Recommendations

While electric motorcycles generally require less frequent maintenance than combustion models, it is essential to follow RGNT's service schedule:

- Service Interval: Every 24 months or 10,000 km – whichever comes first.
- All services must be completed by an authorized RGNT dealer.
- Find authorized service centers at: rgnt-motorcycles.com

IMPORTANT INFORMATION: Failure to follow this service schedule may void your warranty.

12.2 Spare Parts

All RGNT parts and accessories are rigorously tested to meet safety standards and ensure optimal performance. They are specifically designed to integrate seamlessly with the other systems on your motorcycle. Only use RGNT OEM (Original Equipment Manufacturer) parts and accessories. Third-party or non-approved parts may:

- Lead to damage not covered under warranty.
- Compromise safety and performance.
- Render the motorcycle illegal for road use in some countries.

OEM parts and accessories can be purchased through contacting your closest authorized RGNT dealer. If you do not have a dealer in your country, you can contact RGNT Support.

It is strictly forbidden to:

- Remove or alter any original components of the Turbo.
- Modify the wiring or software of the vehicle.
- Replace any component with a part not approved by RGNT.
- Work on the high-voltage system without proper training and certified tools.

IMPORTANT INFORMATION: Unauthorized modifications may render the vehicle unsafe and void your warranty. RGNT Reborn AB assumes no responsibility for injuries or damages resulting from non-approved modifications.

13 Customer Support Information

When contact RGNT Support or an authorized RGNT dealer

Please have the following available when contacting RGNT Reborn AB. As they are essential to effectively and efficiently answer your questions or resolve your concerns.

- Contact name and address
- Contact telephone number
- Vehicle identification number (VIN)
- Place of purchase RGNT Homepage or RGNT Dealer

- Describe your issue as detailed as possible. The date and time you experienced an issue can be of use for us to determine the cause.
- If possible, also provide photos or video to explain the experienced issue.

Contact RGNT Support

Please contact us if you have any questions or need support. The office is open Monday-Friday 08:00-17:00.

Email: support@rgnt-motorcycles.com

Place of factory & headquarters

RGNT Reborn AB

Årnäsvägen 2

432 96 Åskloster

Sweden

14 Warranty

RGNT Reborn AB (RGNT) warrants that, dependent upon the exclusions and limitations set out below, the RGNT vehicle purchased by you will be without defects in materials and workmanship, when used normally, in accordance with our published guidelines. The warranty period is for the time period of two (2) years from the date of delivery.

14.1 Warranty Guidelines

Our published guidelines include but are not restricted to information included on our website, rgnt-motorcycles.com and in the supplied user manuals. In the event that the Product does not meet the warranty standard to our reasonable satisfaction, we will within a commercially reasonable time, free of charge, either repair or replace the Product as described below.

14.2 Warranty Valid Countries

The Warranty is only valid and enforceable for vehicles sold and located within these countries: EU, Norway, Switzerland & UK. If you privately import a RGNT motorcycle to a country that's not included in our warranty, RGNT Reborn AB will NOT be able to assist in any issues that may occur.

14.3 Warranty Claim

If you wish to make a Warranty claim, contact us at support@rgnt-motorcycles.com or an authorized RGNT Dealer.

Write your contact information, what the issue of the claim is, and include the VIN-number of your vehicle. Our company will look after you through the process involved in a claim. Any Warranty claim is subject to you alerting us of the alleged defect within a reasonable time of it coming to your notice and, in any case, by no later than the expiration of the Warranty

Period. If the motorcycle is exported by the owner to a country that's not included in our warranty policy, the Warranty claim will not be approved.

14.4 Repairing and Replacements

During the duration of this Warranty, an authorized RGNT dealer will repair or replace without charge, any RGNT Motorcycle, Battery, or parts within the vehicle warranty time and found by RGNT or an authorized RGNT dealer to be defective in factory materials or workmanship.

14.4.1 Warranty Service

To obtain warranty service, you must notify us within the applicable Warranty Period. The location of the nearest RGNT Authorized Service Partner may be obtained by emailing support@rgnt-motorcycles.com. The location is subject to change at any time and without prior notice.

14.5 Tires

The tires installed on the RGNT Motorcycles, the original equipment tires, are warranted separately by the tire manufacturer (Dunlop tires).

14.6 What is excluded

14.6.1

This Warranty will be invalid if (1) the Product's serial number has been removed or is illegible in any way (as determined by our sole judgment), or (2) the VIN is defaced or altered or the odometer or other related system disconnected, altered or rendered inoperative so that it is difficult to determine the VIN number or actual distance traveled, or (3) the Product has been determined to be a total loss by an insurance company, or (4) you are in breach of the terms of this Warranty or your written agreement with us.

14.6.2

We hereby disclaim any and all indirect, incidental, special and consequential damages arising out of or relating to your Turbo, including, but not limited to, transportation, loss of Turbo value, loss of time, loss of income, loss of use, loss of personal or commercial property, inconvenience or aggravation, emotional distress or harm, commercial loss (including but not limited to lost profits or earnings), towing charges, bus fares, service call charges, gasoline expenses, lodging expenses, damage to tow Turbo, and incidental charges such as telephone calls, facsimile transmissions, and mailing expenses. We shall not be liable for any direct damages in an amount that exceeds the fair market value of the Turbo at the time of the claim. Lone remedy and dispute resolution.

14.6.3

Any cosmetic concerns that arise as a result of environmental conditions, owner abuse, misuse, lack of routine care and maintenance, and/or improper use.

14.6.4

This Warranty supersedes all other RGNT Reborn AB warranties and liabilities, whether oral, written, (non-mandatory) statutory, contractual, in tort or other, including, without restriction, and where allowed by applicable law, any implied conditions, warranties or other terms as to adequate quality or fitness for purpose.

14.6.5

The performance of the necessary repairs and parts replacement by us is the exclusive remedy under this Warranty or any implied warranties.

14.6.6

In the event that any disputes, differences or controversies arise between you and RGNT Reborn AB related to this Warranty, we will explore all possibilities for an amicable settlement. In case an amicable settlement is not reached, we offer a dispute settlement program through the Swedish Court. We require that you submit your dispute to us and wait for a decision to be issued prior to pursuing any other remedy.

14.6.7

Due to the battery chemistry, there is a normal, expected reduction in range/capacity that the battery can yield over time and usage. Depending on use and storage conditions, Power Packs will degrade during the duration of this Limited Warranty period. RGNT will only repair or replace the main battery if that exhibits a nominal storage capacity reduction of greater than 20% of the published nominal capacity, as measured by an authorized RGNT dealer.

14.6.8

Warranty is only covers "Normal operating conditions" If we the bike has been used off road or used for competition on closed circuit warranty will not cover this. If RGNT determine that the vehicle has been negligent and not been taken care of with in "Normal operating conditions" the warranty can be affected.

14.6.9

Damage, malfunctions, or performance problems caused by the installation or use of any charger not sold or approved by RGNT.

14.6.10

The cost of parts and labor involved in any routine care and maintenance and/or the replacement of parts due to normal wear and tear, use, or deterioration, including but not limited to: tires, brake pads, fork seals, grips, foot pegs, and the seat.

14.6.11

Any cosmetic concerns that arise as a result of environmental conditions, owner abuse, misuse, lack of routine care and maintenance, and/or improper use.

14.6.12

Damage, malfunctions, or performance problems caused by the improper repair of the motorcycle, installation of any parts or accessories not sold or approved by RGNT.

14.6.13

Damage, malfunctions, or performance problems caused by modifications or alterations performed by an unauthorized mechanic or outside the RGNT service & repair guidelines.

14.6.14

Damage, malfunctions, or performance problems caused by continued operation of the motorcycle after a warning light, gauge reading, or other warning indicates a mechanical or operational problem.

14.6.15

RGNT reserves the right to change or improve the design of any RGNT Motorcycle at any time, without assuming any obligation to modify any RGNT products previously manufactured or sold.